



- Smart Outlet**
- Reduce Falls at Night
 - Cord Free Operation
 - Turns lights on before residents gets up

Installation and Use Instructions

Smart Outlet

IMPORTANT INFORMATION: Cordless and Wireless Systems rely on wireless technology which is subject to physical and environmental considerations. Please be aware that the transmitter will not be 100% accurate if it is out of range at any time. It is the end-user's responsibility to make sure that the product is used correctly and within range of each other. Cordless and wireless systems and devices are intended as an adjunct to good caregiving practices and are not a substitute for proper staffing and patient management practices. We recommend that all caregivers receive periodic training in the operation of these systems and that the devices are tested daily. It is important to read and follow the directions.

Read the instructions and Legal Disclaimer.

The Smart Caregiver Corporation devices are designed to be installed by the end user. As such, it is the entire responsibility of the buyer to insure that the system is properly installed and tested. Further, the system is not designed to replace good caregiving practices including, but not limited to:

- A.) Direct patient supervision
- B.) Adequate training for staff personnel for fall prevention and elopement
- C.) Testing of the system before each use

WARNING: The manufacturer does not claim that this device will stop elopement and/or stop falls. This device is designed to augment caregivers' comprehensive resident mobility management program. Failure to comply with the warning may result in injury or death. This device is not suitable for all individuals. Other devices may be required. This device is not a substitute for visual monitoring by a caregiver.

Where permissible, it is the seller's intent to limit any liability for special, consequential or incidental economic damages to refund of the purchase price or replacement of the goods. Seller disclaims any liability for compensatory or other damages arising out of the use of the goods.

Limited Warranty: Seller warrants that the goods sold will be free from defects of workmanship and manufacturing, for a warranty period from the date of sale. Other than this limited warranty, seller makes no express or implied warranties. Except for this limited warranty, No express or implied warranties are given and no affirmation of seller, by words or action will constitute a warranty. The goods being purchased are being sold on a "with all faults" basis. The entire risk as to the quality and performance of the goods is with the buyer. Should the goods prove defective following their purchase, the buyer, and not the manufacturer, distributor or retailer, assumes the entire cost of all necessary installation, servicing or repairs.



SMART CAREGIVER CORPORATION

1229 North McDowell Blvd, Petaluma, CA 94954 | Tel: 800-650-3637
 csr@smartcaregiver.com | www.smartcaregiver.com

Smart Outlet with Bed / Chair / Floor Mat Sensor Pad Instructions

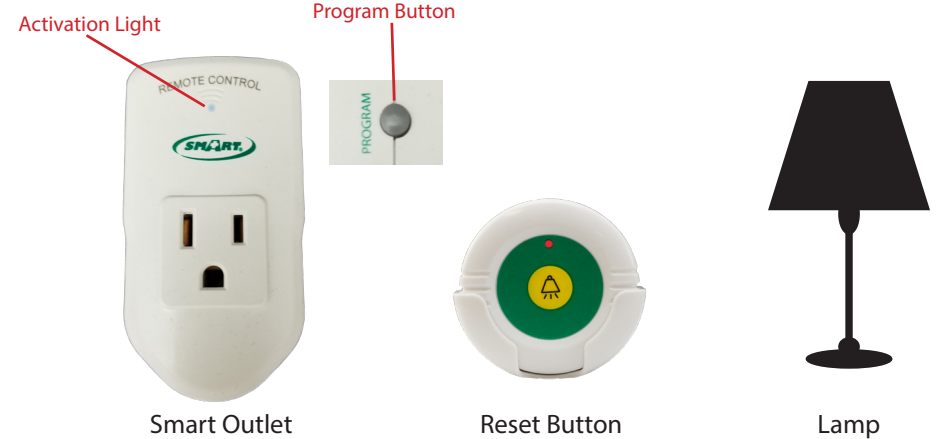

1. Activate pad/floor mat by placing pressure for 30 seconds.
2. Plug Smart Outlet into wall outlet.
3. Plug lamp into front of Smart Outlet.
4. Make sure the switch on the lamp is set to the "ON" position (Lamp should now be on).
5. **TEST** by placing pressure on the sensor pad, and release or stepping on the floor mat.
6. Lamp will turn on.
7. Place pressure back on the pad or press remote reset button; lamp should turn off.



Programming additional or replacement component to your Smart Outlet:

Turn on transmitter before programming.

1. Press and hold Program button on the side of the Smart Outlet until light on front begins to flash. 
2. Activate Component
 - **Bed/Chair Pad:** Apply pressure on the pad for a few seconds and then release pressure
 - **Floor Mat:** Stand on Floor Mat for a few seconds and then step off
 - **Reset Button:** Press and release Reset Button
3. Light on Smart Outlet will turn off.
4. For each additional pad/component you want to add, repeat steps 1 and 2.
5. Test before putting into use.

Smart Outlet with Bed / Chair / Floor Mat Sensor Pad Instructions



Activation Light



1. Activate pad/floor mat by placing pressure for 30 seconds.

2. Plug Smart Outlet into wall outlet.

3. Plug lamp into front of Smart Outlet.

4. Make sure the switch on the lamp is set to the "ON" position

(Lamp should now be on).

5. **TEST** by placing pressure on the sensor pad, and release or stepping on the floor mat.

6. Lamp will turn on.

7. Place pressure back on the pad or press remote reset button; lamp should turn off.

Programming additional or replacement component to your Smart Outlet:

Turn on transmitter before programming.

1. Press and hold Program button on the side of the Smart Outlet until light on front begins to flash.



2. Activate Component

• **Bed/Chair Pad:** Apply pressure on the pad for a few seconds and then release pressure

• **Floor Mat:** Stand on Floor Mat for a few seconds and then step off

• **Reset Button:** Press and release Reset Button

3. Light on Smart Outlet will turn off.

4. For each additional pad/component you want to add, repeat steps 1 and 2.

5. Test before putting into use.



- ### Smart Outlet
- Reduce Falls at Night
 - Cord Free Operation
 - Turns lights on before residents get up



Smart Outlet

IMPORTANT INFORMATION: Cordless and Wireless Systems rely on wireless technology which is subject to physical and environmental considerations. Please be aware that the transmitter will not be 100% accurate if it is out of range at any time. It is the end-user's responsibility to make sure that the product is used correctly and within range of each other. Cordless and wireless systems and devices are intended as an adjunct to good caregiving practices and are not a substitute for proper staffing and patient management practices. We recommend that all caregivers receive periodic training in the operation of these systems and that the devices are tested daily. It is important to read and follow the directions.

Read the instructions and Legal Disclaimer:

The Smart Caregiver Corporation devices are designed to be installed by the end user. As such, it is the entire responsibility of the buyer to insure that the system is properly installed and tested. Further, the system is not designed to replace good caregiving practices including, but not limited to:

A.) Direct patient supervision
 B.) Adequate training for staff personnel for fall prevention and elopement
 C.) Testing of the system before each use

WARNING: The manufacturer does not claim that this device will stop elopement and/or stop falls. This device is designed to augment caregivers' comprehensive resident mobility management program. Failure to comply with the warning may result in injury or death. This device is not suitable for all individuals. Other devices may be required. This device is not a substitute for visual monitoring by a caregiver.

Where permissible, it is the seller's intent to limit any liability for special, consequential or incidental economic damages to refund of the purchase price or replacement of the goods. Seller disclaims any liability for compensatory or other damages arising out of the use of the goods.

Limited Warranty: Seller warrants that the goods sold will be free from defects of workmanship and manufacturing, for a warranty period from the date of sale. Other than this limited warranty, seller makes no express or implied warranties. Except for this limited warranty, no express or implied warranties are given and no affirmation of seller, by words or action will constitute a warranty. The goods being purchased are being sold on a "with all faults" basis. The entire risk as to the quality and performance of the goods is with the buyer. Should the goods prove defective following their purchase, the buyer, and not the manufacturer, distributor or retailer, assumes the entire cost of all necessary installation, servicing or repairs.